

## MANUFACTURER

Brevis Marek Ćwikilewicz  
Krzysztof Dzieża  
Cholerzyn 456  
32-060 Liszki  
tel. 12 425 31 64  
info@brevis.com.pl  
www.brevis.com.pl

## OVERVIEW

- Insolio One is an automatic air vent installed between the window frame and the reveal. The Insolio vent consists of three main components: an airflow regulator mounted on the interior side of the window, a through duct mounted above the window, and an air intake mounted on the exterior side of the window.
- The airflow regulator allows manual adjustment of the supplied air volume and can be closed down to the infiltration level.
- The through duct is highly resistant to frost and features automatic regulation of the supplied air volume, depending on the difference between external and internal pressure.

## INTENDED USE

- The Insolio One air vent is designed to supply outdoor air to rooms intended for permanent or temporary human occupancy in residential buildings, collective housing (including hotels), public utility buildings, office buildings, and utility spaces, in rooms with:
  - natural ventilation,
  - mechanical exhaust or hybrid ventilation, i.e., natural ventilation integrated with and at least periodically assisted by mechanical exhaust ventilation.
- Use in accordance with PN-83/B-03430 and applicable regulations, or according to the individual guidelines of the designer of the building in which the Insolio One vents are installed.

## CAUTION

- In rooms containing an open flame source (e.g., gas stove), the regulator must always be set to the fully open position.
- Under no circumstances should the outlet openings of the regulator or the inlet openings of the air intake be sealed or covered.
- Do not use any type of filter inserts installed in the inlet slot under the regulator.
- Do not use any additional components not approved by the manufacturer.
- Failure to comply with the above points may disrupt the operation of the ventilation system, which could pose a risk to health or life.

## TECHNICAL DATA

- Nominal airflow  $\Delta p = 10$  Pa Insolio One  
Ventillator open: 26,9 m<sup>3</sup>/h  
Ventillator closed: 7,7 m<sup>3</sup>/h
- Airflow  $\Delta p = 20$  Pa Insolio One  
Ventillator open: 37,5 m<sup>3</sup>/h  
Ventillator closed: 11,4 m<sup>3</sup>/h
- Acoustic insulation Insolio One  
Ventillator open:  $D_{n,e,w} = 52$  (-1, -3) dB  
Ventillator closed:  $D_{n,e,w} = 56$  (-1, -4) dB
- Resistance to rainwater penetration  
600 Pa
- Materials  
Aluminium, ABS/ASA, EPP

### REGULATION

1.

CLOSED

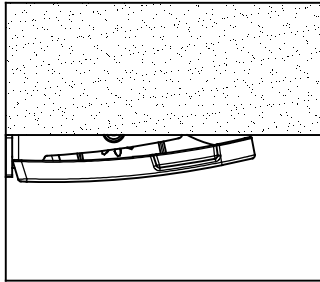

2.

OPEN

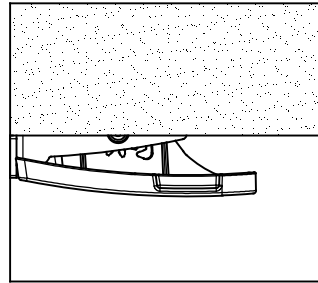

3. Setting the regulator to an intermediate position between “closed” and “open” allows manual adjustment of the supplied airflow rate.

### MAINTENANCE

The Insolio One air vent is a maintenance-free device. In case of heavy contamination, it is recommended to:

- Remove the interior airflow regulator by unclicking it from its supports and clean its components with a damp cloth.
- After removing the regulator, blow through the through duct with an air stream.
- Remove the exterior inspection cover and the air intake cover by unscrewing the fastening screws and clean the components of the air intake.

### REGULATOR REMOVAL

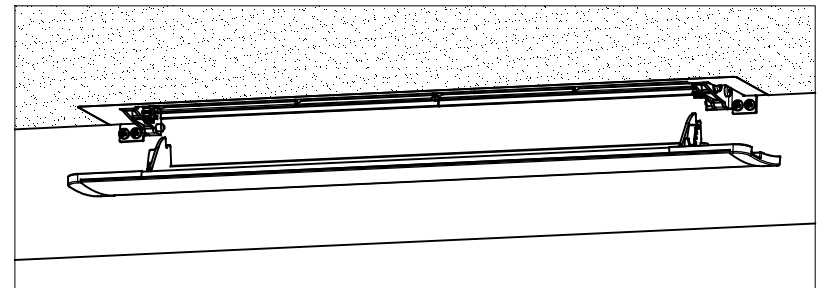
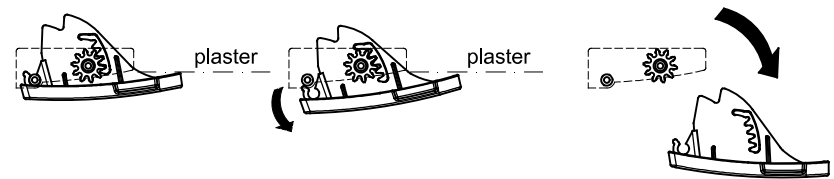

MAINTENANCE

